

40° 86°30'

U.S. DEPARTMENT OF AGRICULTURE
FOREST SERVICE
R.V. STUART, FORESTER

HIAWATHA NATIONAL FOREST MICHIGAN MICHIGAN MERIDIAN 1931

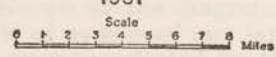

— National Forest Boundary

DIAGRAM FORMING PART OF PROCLAMATION DATED JANUARY 16, 1931

Compiled under the direction of
T.W. Norcross, Chief Engineer, from
General Land Office survey plats, 1930.

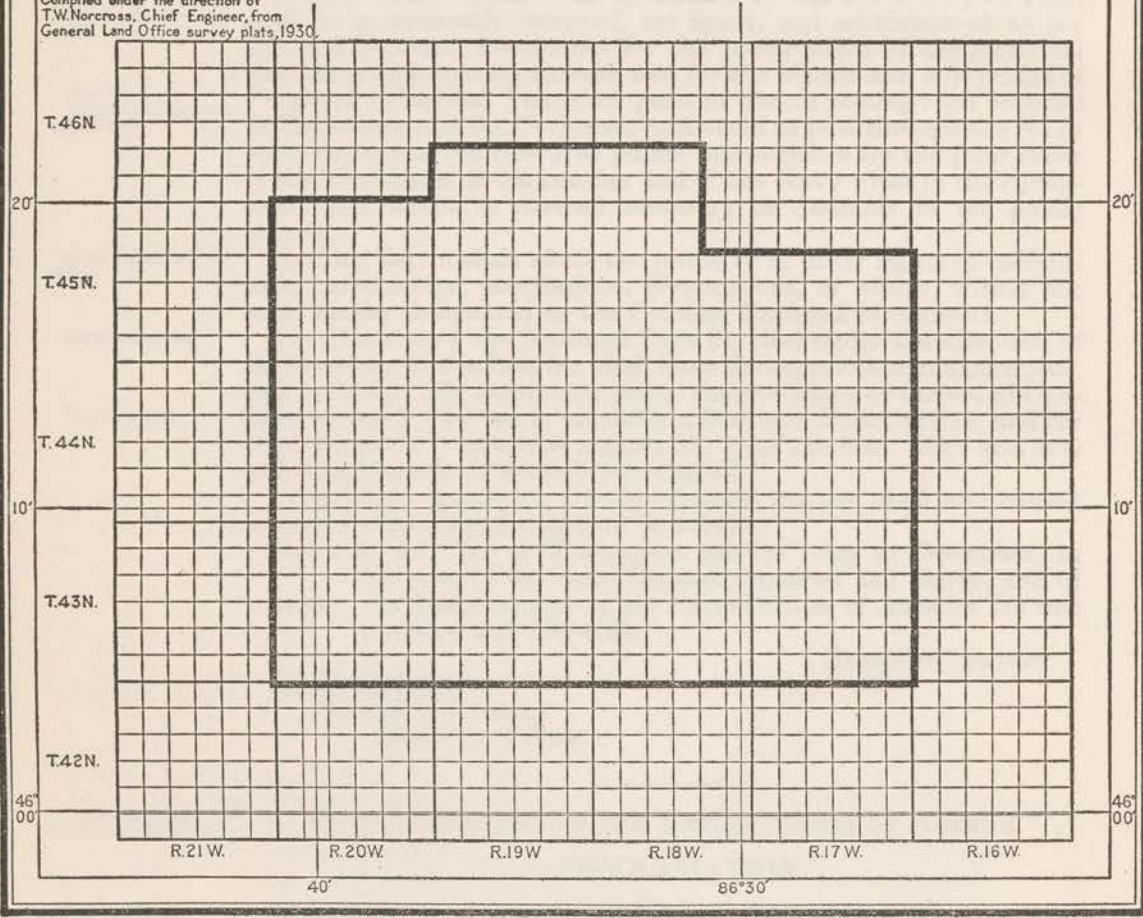

all of the following described lands: unsurveyed Tps. 37 and 38 S., R. 4 W., Salt Lake meridian, not now included in said park; and

WHEREAS the said Secretary of the Interior and the said Secretary of Agriculture have jointly recommended the addition to the park of the lands hereinafter described; and

WHEREAS it appears that the public interests would be promoted by including such lands within said park for the preservation of their natural state and outstanding scenic features and for road protection purposes;

NOW, THEREFORE, I, HERBERT HOOVER, President of the United States of America, do proclaim that the lands hereinafter described shall be, and they are hereby, added to and included within the Bryce Canyon National Park and as part of said park shall be, and they are hereby, made subject to the provisions of the act of August 25, 1916 (39 Stat. 535), entitled "An act to establish a National Park Service, and for other purposes," and all acts supplementary thereto and amendatory thereof and all other laws and rules and regulations applicable to and extending over the said park:

Area enlarged.

Supervision.
Vol. 39, p. 535.

SALT LAKE MERIDIAN

Description.

Unsurveyed T. 37 S., R. 4 W.: S. ½ sec. 2, S. ½ SE. ¼ sec. 3, S. ½, NE. ¼ sec. 10, secs. 11, 14, 15, E. ½, E. ½ SW. ¼ sec. 16, E. ½ SE. ¼ sec. 20, secs. 21, 22, 23, W. ½ sec. 27, sec. 28, E. ½, E. ½ SW. ¼ sec. 29, S. ½ sec. 31, sec. 32, and N. ½ sec. 33.

Unsurveyed T. 38 S., R. 4 W.: secs. 5, 6, 7, W. ½ sec. 8, W. ½ sec. 17, sec. 18, E. ½ sec. 19, secs. 20, 21, W. ½ W. ½ sec. 22, W. ½ W. ½ sec. 27, secs. 28, 29, E. ½ sec. 30, E. ½ sec. 31, sec. 32, W. ½, NE. ¼ sec. 33, and W. ½ NW. ¼ sec. 34.

Lands affected.

Nothing herein shall affect any privately owned lands within this area or any valid existing claim, location, or entry on said lands made under the land laws of the United States, but if any of the privately owned lands shall be conveyed to the United States or any existing claim, location, or entry is canceled, the lands so affected shall become a part of the said Bryce Canyon National Park.

IN WITNESS WHEREOF, I have hereunto set my hand and caused the seal of the United States to be affixed.

DONE at the City of Washington this 5 day of January, in the year of our Lord nineteen hundred and thirty-one, and of the [SEAL] Independence of the United States of America the one hundred and fifty-fifth.

HERBERT HOOVER

By the President:
HENRY L STIMSON
Secretary of State.

BY THE PRESIDENT OF THE UNITED STATES OF AMERICA

January 16, 1931.

A PROCLAMATION

WHEREAS certain forest lands within the State of Michigan have been or may hereafter be acquired by the United States of America under authority of the act of Congress approved March 1, 1911 (36 Stat. 962, U. S. Code, title, 16 sec. 516), as amended June 7, 1924 (43 Stat. 653, U. S. Code, title 16, sec. 515); and

Hiawatha National Forest, Mich. Preamble. Acquisitions, under Conservation Act. Vol. 36, p. 962; Vol. 43, pp. 653, 1215. U. S. C., p. 424.

WHEREAS certain public lands in said State are in part covered with timber or undergrowth and it appears that it would be in the public interest to give them a national-forest status;

Reserving site for national forest.
Vol. 26, p. 1103; Vol. 34, p. 1271; Vol. 36, p. 963.
U. S. C., pp. 419, 425.

NOW, THEREFORE, I, HERBERT HOOVER, President of the United States of America, by virtue of the power in me vested by section 24 of the act of March 3, 1891 (26 Stat. 1103, U. S. Code, title 16, sec. 471), and by section 11 of the act of March 1, 1911 (36 Stat. 963, U. S. Code, title 16, sec. 521), do proclaim that there are hereby reserved and set apart as the Hiawatha National Forest all lands of the United States within the area shown on the diagram attached hereto and made a part hereof, and that all lands therein which may hereafter be acquired by the United States under authority of said acts of March 1, 1911, and June 7, 1924, shall be reserved and administered as part of said Hiawatha National Forest.

Reserved from settlement.

Legal rights not affected.

This proclamation will not take effect upon any lands withdrawn or reserved at this date from settlement, entry, or other appropriation, for any purpose other than forestry uses, or which are at this date legally appropriated under the public land laws, so long as such appropriation is legally maintained, or such withdrawal or reservation exists.

Warning is hereby given to all persons not to make settlement upon the lands reserved by this proclamation.

IN WITNESS WHEREOF, I have hereunto set my hand and caused the seal of the United States to be affixed.

DONE at the City of Washington this 16th day of January, in the year of our Lord nineteen hundred and thirty-one, and of the Independence of the United States of America the one hundred and fifty-fifth.

HERBERT HOOVER

By the President:
HENRY L STIMSON
Secretary of State.

January 27, 1931.

BY THE PRESIDENT OF THE UNITED STATES OF AMERICA

A PROCLAMATION

Ottawa National Forest, Mich.
Preamble.
Acquisitions, under Conservation Act.
Vol. 36, p. 962; Vol. 43, pp. 653, 1215.
U. S. C., p. 424.

WHEREAS certain forest lands within the State of Michigan have been or may hereafter be acquired by the United States of America under authority of the act of Congress approved March 1, 1911 (36 Stat. 962; U. S. Code, title 16, sec. 516), as amended June 7, 1924 (43 Stat. 653; U. S. Code, title 16, sec. 515); and

WHEREAS certain public lands in said State are in part covered with timber or undergrowth and it appears that it would be in the public interest to give them a national-forest status;

Reserving site for national forest.
Vol. 26, p. 1103; Vol. 34, p. 1271; Vol. 36, p. 963.
U. S. C., pp. 419, 425.

NOW, THEREFORE, I, HERBERT HOOVER, President of the United States of America, by virtue of the power in me vested by section 24 of the act of March 3, 1891 (26 Stat. 1103; U. S. Code, title 16, sec. 471), and by section 11, act of March 1, 1911 (36 Stat. 963; U. S. Code, title 16, sec. 521), do proclaim that there are hereby reserved and set apart as the Ottawa National Forest all lands of the United States within the area shown on the diagram attached hereto and made a part hereof, and that all lands therein which may hereafter be acquired by the United States under the authority of said acts of March 1, 1911, and June 7, 1924, shall be reserved and administered as part of said Ottawa National Forest.

Legal rights not affected.

This proclamation will not take effect upon any lands withdrawn or reserved, at this date, from settlement, entry, or other appropriation, for any purpose other than forest uses, or which are at this date legally appropriated under the public land laws, so long as such appropriation is legally maintained, or such withdrawal or reservation exists.